

EL 1410  
EL 1410

- GENERAL NOTES**
- All work indicated on these plans shall be done in conformity with applicable provisions of Specifications No. 2281 and Standard Drawing No. 2321.
  - Retain Curb for driveways where necessary, except locations of walls to be observed in the field.
  - Removal of Obstructions
    - To be removed under this contract.
    - To be removed and replaced by others.
    - To be removed and replaced under this contract.
  - Check Mark No. 32, E.L. 1400-37.
  - Remove existing asphalt base of P.M.S. for new Curb & Gutter Construction.
  - Construct P.C.C. Gutter of all Driveway.

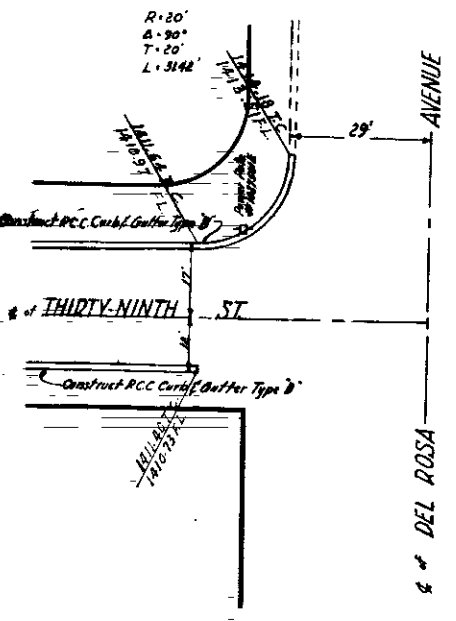

INTERSECTION DETAIL  
Scale 1"=20'

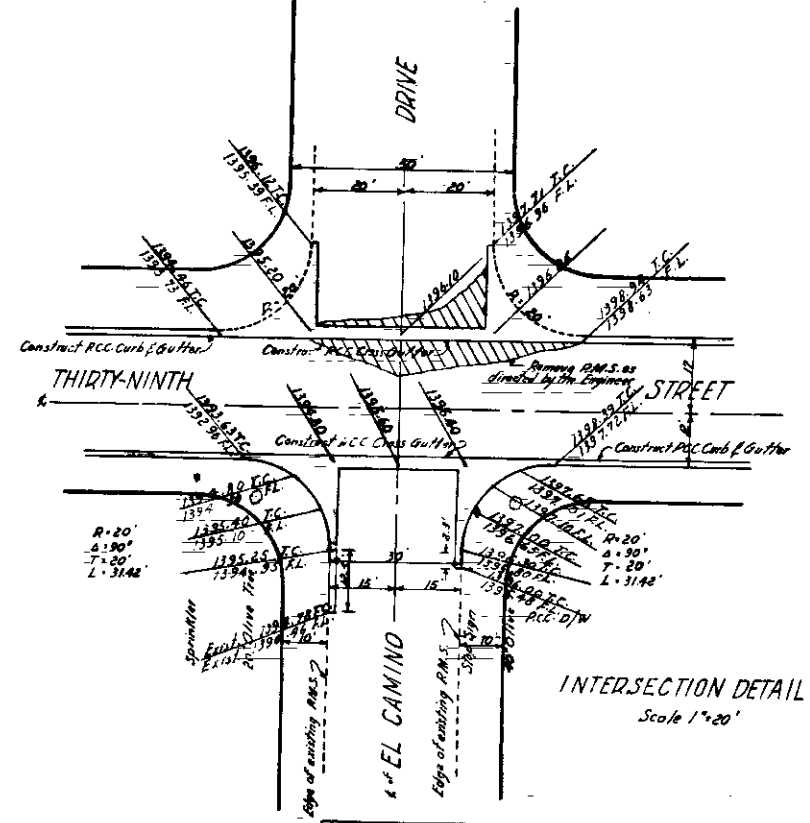
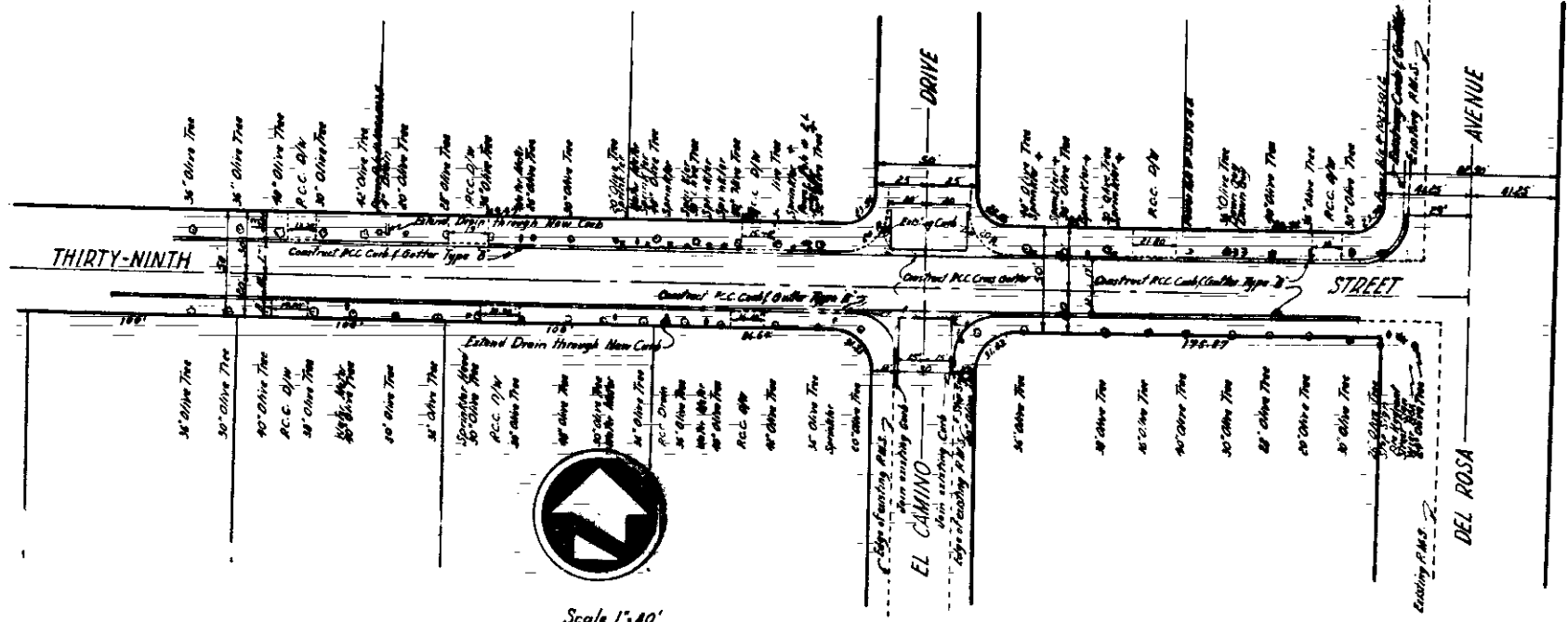

INTERSECTION DETAIL  
Scale 1"=20'

DEPARTMENT OF ENGINEERING  
CITY OF SAN BERNARDINO

THIRTY-NINTH STREET  
Between Mountain Avenue & Del Rosa Avenue

Curb & Gutter

SUBMITTED BY	REFERENCE	DRAWN BY
APPROVED	MAY 14 1929	2620
CITY ENGINEER	CHECKED BY	SHEET 6
REGISTERED CIVIL ENGINEER NO. 7171		OF 75